

W Series Frame Backer Bar

Spec sheet for FCF-BACK

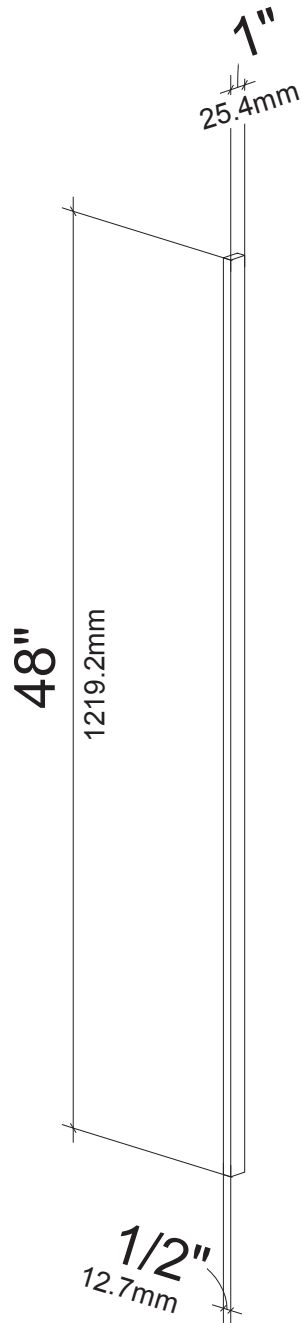

The W Series Frame Backer Bar is required for all W Series Frame displays greater than 60" and with one side of wine racking only.

The Backer Bar must cover a minimum of 12" above and below any connection point between two sections of W Series Frames.



VINTAGEVIEW®
MOVING WINE STORAGE FORWARD

4690 Joliet St., Denver, CO 80239 | phone: 866.650.1500 | fax: 866.650.1501 | VintageView.com

For product warranty information, please visit: VintageView.com/support/warranty. We're here to help, call us at 866-650-1500 with any questions